



Service Parts Kits

Pump Models

PP66S10 SC66S10 VP66S10

The mechanical seal kit and bearing frame kit are offered separately. We recommend ordering both kits for a major service.

Both the Mechanical Seal and Bearing Frame kits include all of the O-rings needed for service.

| Part Number | Description |
|-------------|---------------------------------------|
| 372000105 | Mechanical Seal Kit, includes O-rings |
| 373000109 | Bearing Frame Kit, includes O-rings |

PN 372000105 Mechanical Seal Kit

| Qty | Item # | Description |
|-----|----------|------------------------------|
| 1 | 12721153 | Shim 1.75 X .78 X .005 |
| 1 | 12721154 | Shim 1.75 X .78 X .010 |
| 1 | 12721155 | Shim 1.75 X .78 X .015 |
| 1 | 30148243 | O-Ring, Seal Gland |
| 2 | 30148273 | O-Ring, Volute/Suction Cover |
| 1 | 30148336 | O-Ring, Cleanout Cover |
| 1 | 30148260 | O-Ring, Bearing Plate |
| 1 | 30148165 | O-Ring, Bearing Cover/SAE |
| 4 | 30148018 | O-Ring, Oil Return |
| 1 | 30400171 | Mechanical Seal |
| 1 | 12227121 | Impeller Key |
| 1 | 37500133 | Impeller Lock Washer |
| 1 | 30500153 | Lip Seal |
| 1 | 34800104 | P-80 Lubricant, 10ML |
| 1 | 34800105 | Loctite 263, 0.5ML |

PN 373000109 Bearing Frame Kit

| Qty | Item # | Description |
|-----|--------------|------------------------------|
| 1 | 12721104 | Shim 6.68 X 5.69 X .005 |
| 1 | 12721105 | Shim 6.68 X 5.69 X .010 |
| 1 | 12721106 | Shim 6.68 X 5.69 X .015 |
| 1 | 31900121 | Pump End Bearing |
| 1 | 31900122 | Drive End Bearing |
| 1 | 353005100196 | Snap Ring |
| 1 | 30148243 | O-Ring, Seal Gland |
| 2 | 30148273 | O-Ring, Volute/Suction Cover |
| 1 | 30148336 | O-Ring, Cleanout Cover |
| 1 | 30148260 | O-Ring, Bearing Plate |
| 1 | 30148165 | O-Ring, Bearing Cover/SAE |
| 4 | 30148018 | O-Ring, Oil Return |
| 3 | 31858118 | Tapered Rubber Plug |
| 2 | 30500188 | Cassette Seal |
| 1 | 30500153 | Lip Seal |

Service Parts Kits

Pump Models
PP66S10 SC66S10 VP66S10

Ordering Information

Parts Kits are in stock and available for shipment within 2 business days.
Please call or fax orders. Phone (503) 266-4115, Fax (503) 266-4116.
Email: Canbyparts@pioneerpump.com.

| Part Number | Description |
|-------------|----------------------------|
| 372000105 | Mechanical Seal Repair Kit |
| 373000109 | Bearing Frame Repair Kit |

Optional Parts

Additional parts for this model.

| Model | Description | Part Number |
|-------|---|-------------|
| 66S10 | Wear Ring | 109026810 |
| 66S10 | Impeller CA6NM SS | 1123007610 |
| | Seal Installation Tool for 2.50" Shafts | |
| 66S10 | Installation Tool | 3671710236B |

Notes:

1. Part numbers listed reflect updated part numbers as of July 11, 2016. Older documentation may have different part numbers. Please consult factory if differences appear.
2. Viton O-rings are included when available.



310 South Sequoia Parkway, Canby, OR 97013 USA
Phone (503) 266-4115 ■ Fax (503) 266-4116
www.pioneerpump.com

Parts Drawing - 372000105 Mechanical Seal Parts Kit

Pump Models

PP66S10
SC66S10
VP66S10

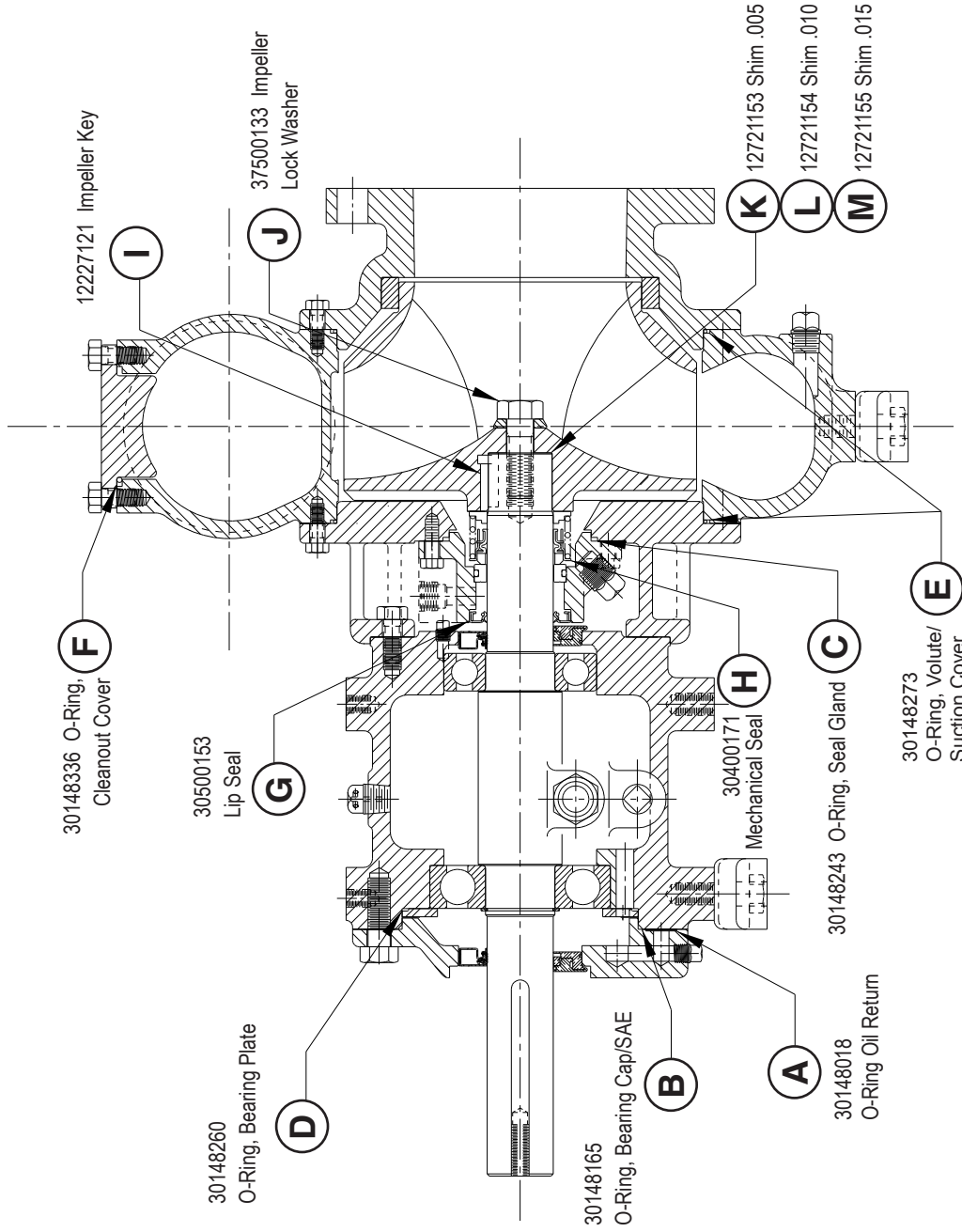

| PN 372000105 Mechanical Seal Kit | | |
|----------------------------------|--------------------------------|------|
| Ref. Item Number | Description | Qty. |
| A | O-Ring, Oil Return | 4 |
| B | O-Ring, Bearing Cap/SAE | 1 |
| C | O-Ring, Seal Gland | 1 |
| D | O-Ring, Bearing Plate | 1 |
| E | O-Ring, Volute/Suction Cover 2 | 2 |
| F | O-Ring, Cleanout Cover | 1 |
| G | Lip Seal | 1 |
| H | Mechanical Seal | 1 |
| I | Impeller Key | 1 |
| J | Impeller Lock Washer* | 1 |
| K | Shim, .005 Thick | 1 |
| L | Shim, .010 Thick | 1 |
| M | Shim, .015 Thick | 1 |
| N/A | P-80 Lubricant, 10 mL | 1 |
| N/A | Loctite 263, 0.5 mL | 1 |

*Torque Specification: 330 lb-ft



310 South Sequoia Parkway, Canby, OR 97013 USA
Phone (503) 266-4115 ■ Fax (503) 266-4116
www.pioneerpump.com

Parts Drawing - 373000109 Bearing Frame Parts Kit

Pump Models

PP66S10

SC66S10

VP66S10

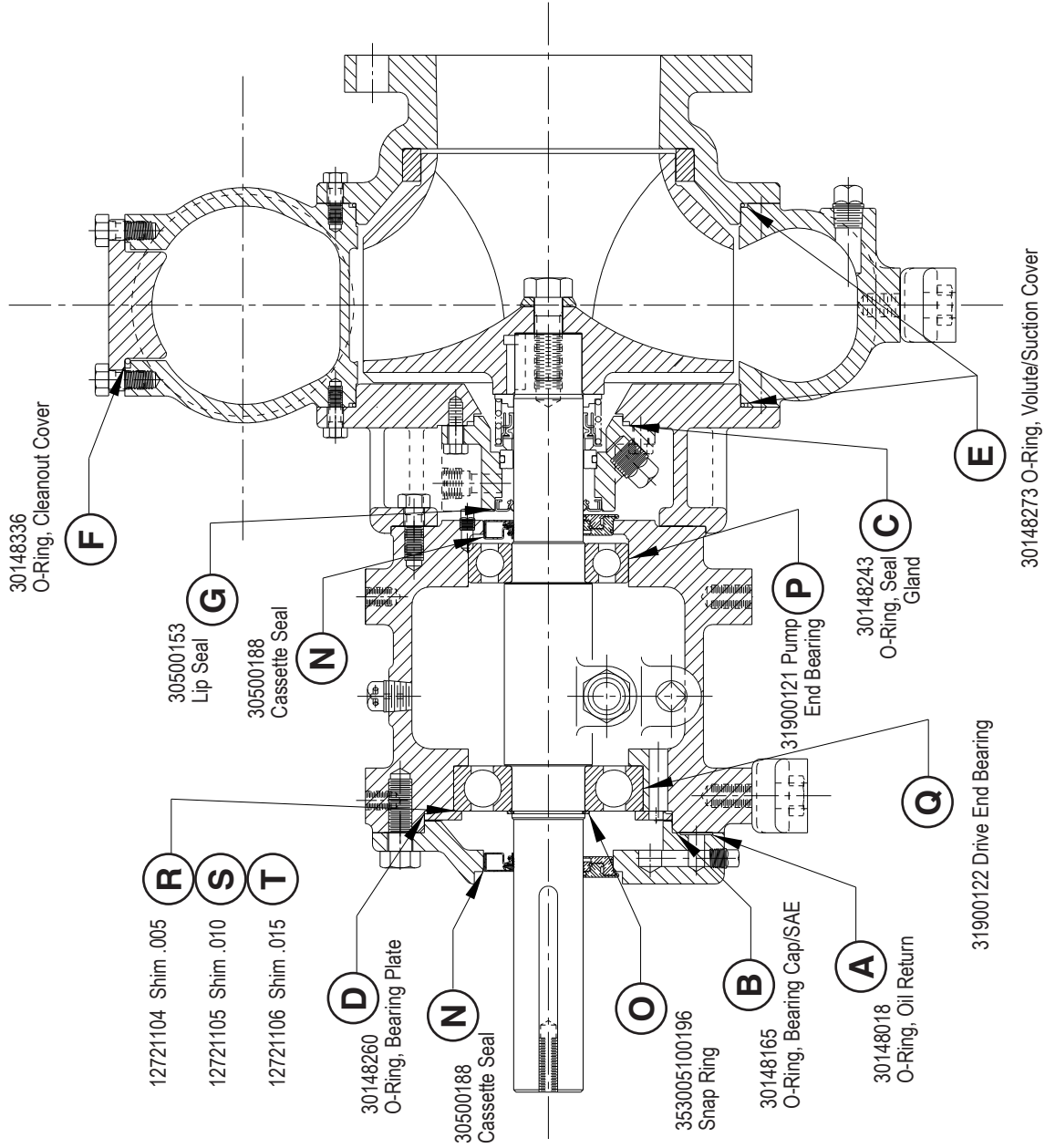

| PN 373000109 Bearing Frame Kit | | | |
|--------------------------------|---------------------------------------|------|--|
| Ref. Item Number | Description | Qty. | |
| A | 30148018 O-Ring, Oil Return | 4 | |
| B | 30148165 O-Ring, Bearing Cap/SAE | 1 | |
| C | 30148243 O-Ring, Seal Gland | 1 | |
| D | 30148260 O-Ring, Bearing Plate | 1 | |
| E | 30148273 O-Ring, Volute/Suction Cover | 2 | |
| F | 30148336 O-Ring, Cleanout Cover | 1 | |
| G | 30500153 Lip Seal | 1 | |
| N | 30500188 Cassette Seal | 2 | |
| O | 353005100196 Snap Ring | 1 | |
| P | 31900121 Pump End Bearing | 1 | |
| Q | 31900122 Drive End Bearing | 1 | |
| R | 12721104 Shim, .005 Thick | 1 | |
| S | 12721105 Shim, .010 Thick | 1 | |
| T | 12721106 Shim, .015 Thick | 1 | |
| N/A | 31858118 Tapered Rubber Plug | 3 | |



310 South Sequoia Parkway, Canby, OR 97013 USA
 Phone (503) 266-4115 ■ Fax (503) 266-4116
www.pioneerpump.com