



Service Parts Kits

Pump Models

PP44S8 SC44S8 VP44S8

The mechanical seal kit and bearing frame kit are offered separately. We recommend ordering both kits for a major service.

Both the Mechanical Seal and Bearing Frame kits include all of the O-rings needed for service.

Part Number	Description
372000108	Mechanical Seal Repair Kit, includes O-rings
373000106	Bearing Frame Repair Kit, includes O-rings

PN 372000108 Mechanical Seal Kit

Qty	Item #	Description
1	30400171	Mechanical Seal
1	12721153	Shim 1.75 X .78 X .005
1	12721154	Shim 1.75 X .78 X .010
1	12721155	Shim 1.75 X .78 X .015
4	30148018	O-Ring, Drain Back
1	30148260	O-Ring, Bearing Plate
1	30148165	O-Ring, Bearing Cap
1	30148243	O-Ring, Seal Gland
1	30148336	O-Ring, Clean Out Cover
2	30148370	O-Ring, Volute/Suction Cover
1	12227121	Key, Impeller
1	34800104	P-80 Lubricant, 10ML
1	34800105	Loctite 263, 0.5ML
1	37500133	Impeller Lock Washer Kit
1	30500153	Lip Seal

PN 373000106 Bearing Frame Kit

Qty	Item #	Description
1	31900121	Bearing
1	31900122	Bearing
1	12721104	Shim 6.68 X 5.69 X .005
1	12721105	Shim 6.68 X 5.69 X .010
1	12721106	Shim 6.68 X 5.69 X .015
1	353005100196	Snap Ring
4	30148018	O-Ring, Drain Back
1	30148165	O-Ring, Bearing Cap
1	30148243	O-Ring, Seal Gland
1	30148336	O-Ring, Clean Out Cover
2	30148370	O-Ring, Volute/Suction Cover
1	30148260	O-Ring, Bearing Plate
2	30500188	Cassette Seal
1	30500153	Lip Seal
3	31858118	Tapered Rubber Plug

Service Parts Kits

Pump Models

PP44S8 SC44S8 VP44S8

Ordering Information

Parts Kits are in stock and available for shipment within 2 business days.

Please call or fax orders. Phone (503) 266-4115, Fax (503) 266-4116.

Email: Canbyparts@pioneerpump.com.

Part Number	Description
372000108.....	Mechanical Seal Kit
373000106.....	Bearing Frame Kit

Optional Parts

Additional replacement parts for this model.

Model	Description	Part Number
44S8	Wear Ring.....	109026037
44S8	Impeller, CA6AM SS.....	1123008822R

Seal Installation Tool for 2.50" Shafts

44S8/44S10..... Installation Tool.....3671710236A

Notes:

1. Part numbers listed reflect updated part numbers as of July 11,2016. Older documentation may have different part numbers. Please consult factory if differences appear.
2. Viton O-rings are included when available.



310 South Sequoia Parkway, Canby, OR 97013 USA

Phone (503) 266-4115 ■ Fax (503) 266-4116

www.pioneerpump.com

Parts Drawing - 372000108 Mechanical Seal Parts Kit

Pump Models
PP44S8
SC44S8
VP44S8

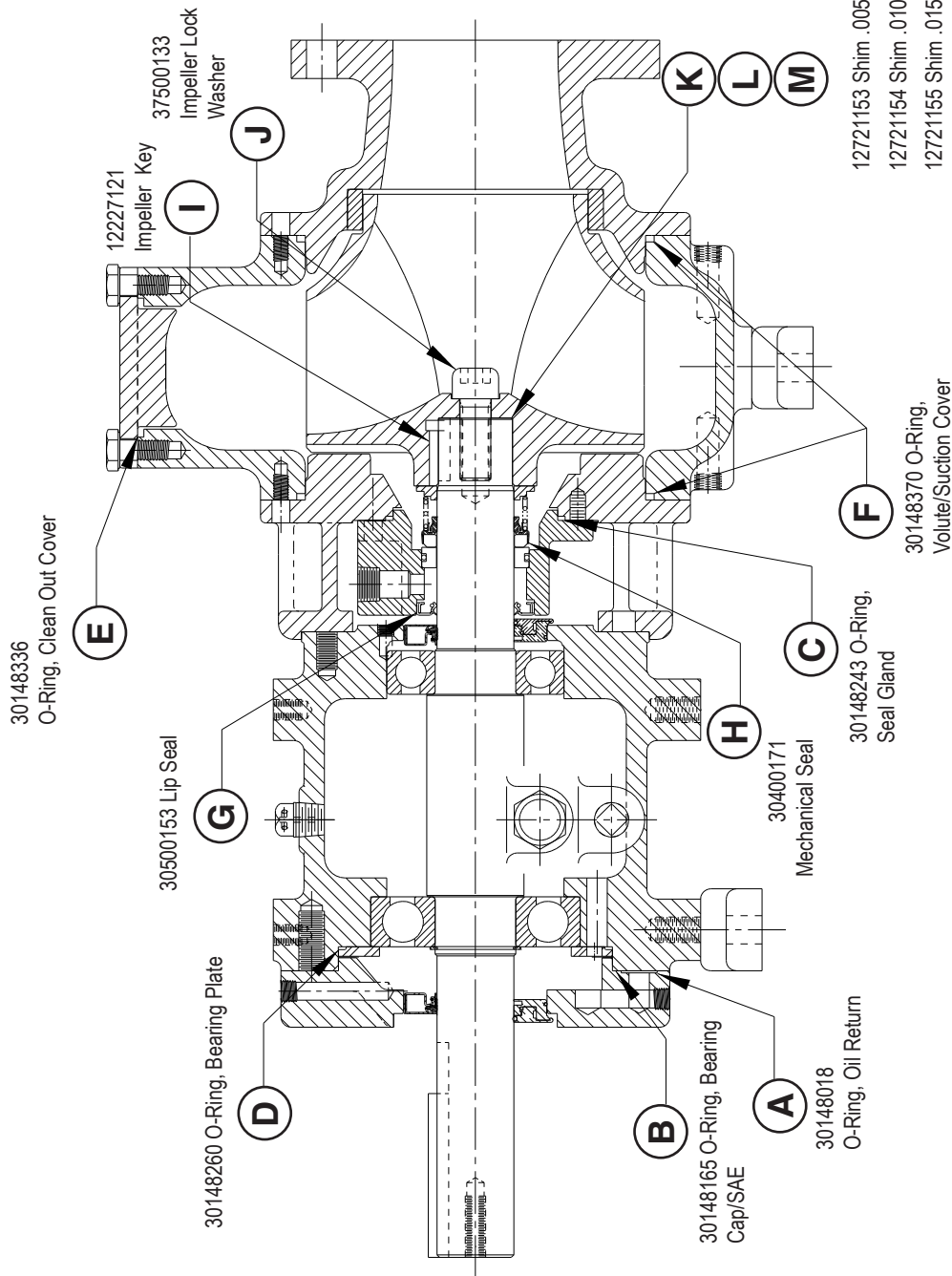

PN 372000108 Mechanical Seal Kit

Ref.	Item Number	Description	Qty.
A	30148018	O-Ring, Oil Return	4
B	30148165	O-Ring, Bearing Cap/SAE	1
C	30148243	O-Ring, Seal Gland	1
D	30148260	O-Ring, Bearing Plate	1
E	30148336	O-Ring, Cleanout Cover	1
F	30148370	O-Ring, Volute/Suction Cover	2
G	30500153	Lip Seal	1
H	30400171	Mechanical Seal	1
I	12227121	Impeller Key	1
J	37500133	Impeller Lock Washer*	1
K	12721153	Shim, .005 Thick	1
L	12721154	Shim, .010 Thick	1
M	12721155	Shim, .015 Thick	1
N/A	34800104	P-80 Lubricant, 10 mL	1
N/A	34800105	Loctite 263, 0.5 mL	1

*Torque Specification: 330 lb-ft



310 South Sequoia Parkway, Canby, OR 97013 USA
 Phone (503) 266-4115 ■ Fax (503) 266-4116
www.pioneerpump.com

Parts Drawing - 373000106 Bearing Frame Kit

Pump Models
PP44S8
SC44S8
VP44S8

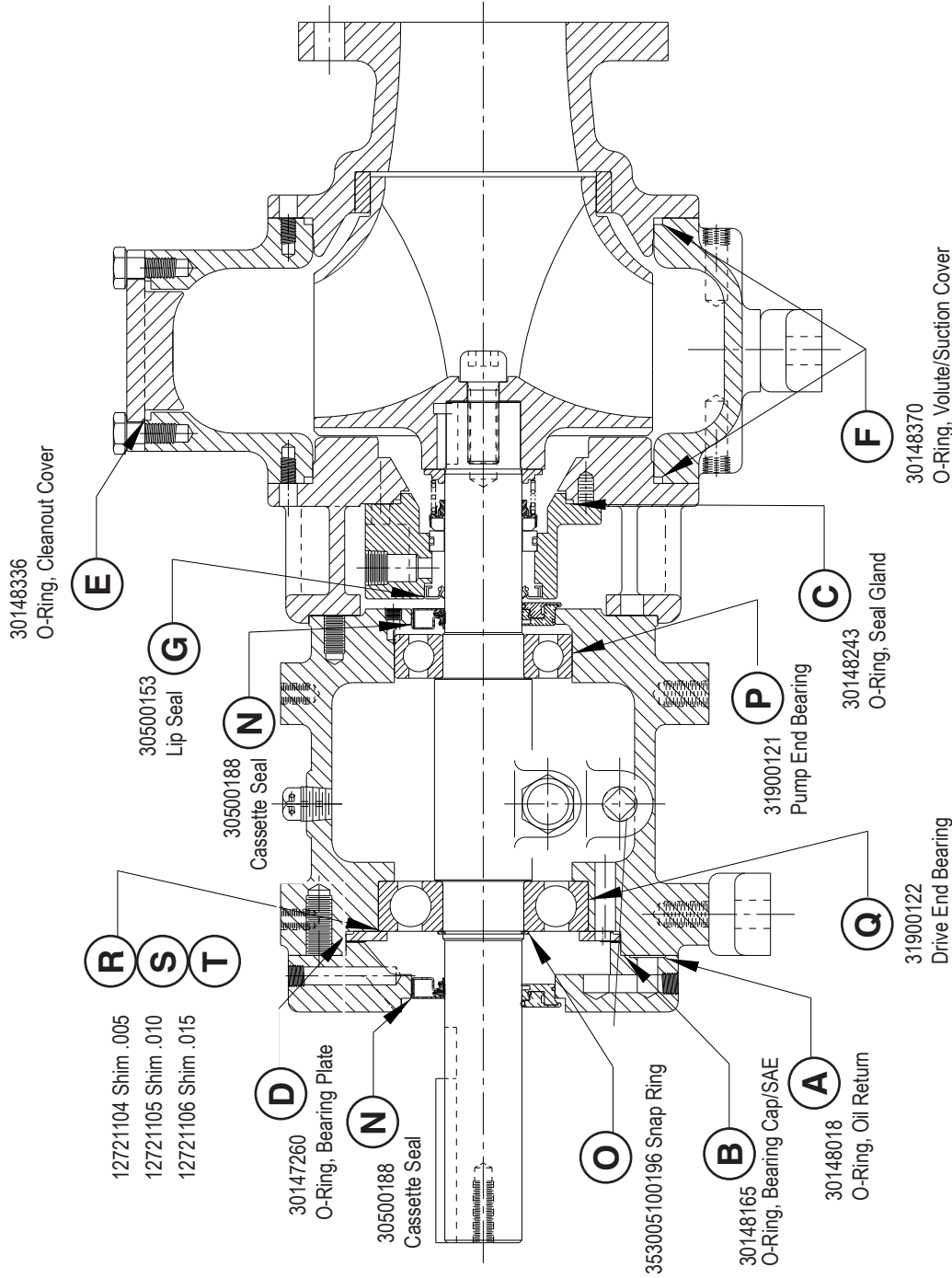

PN 373000106 Bearing Frame Kit			
Ref. Item Number	Description	Qty.	
A	O-Ring, Oil Return	4	
B	O-Ring, Bearing Cap/SAE	1	
C	O-Ring, Seal Gland	1	
D	O-Ring, Bearing Plate	1	
E	O-Ring, Cleanout Cover	1	
F	O-Ring, Volute/Suction Cover	2	
G	Lip Seal	1	
N	Cassette Seal	2	
O	Snap Ring	1	
P	Pump End Bearing	1	
Q	Drive End Bearing	1	
R	Shim, .005 Thick	1	
S	Shim, .010 Thick	1	
T	Shim, .015 Thick	1	
N/A	Tapered Rubber Plug	3	



310 South Sequoia Parkway, Canby, OR 97013 USA
 Phone (503) 266-4115 ■ Fax (503) 266-4116
www.pioneerpump.com