



Service Parts Kits

Pump Models		
PP108C24	SC108C24	VP108C24
PP128S22	SC128S22	VP128S22

The mechanical seal kit and bearing frame kit are offered separately. We recommend ordering both kits for a major service.

Both the Mechanical Seal and Bearing Frame kits include all of the O-rings needed for service.

Part Number	Description
372000122	Mechanical Seal Repair Kit, includes O-rings
373000118	Bearing Frame Repair Kit, includes O-rings

PN 372000122 Mechanical Seal Kit

Qty	Item #	Description
1	1272110511	Shim .010"
1	1272110512	Shim .015"
1	30400190	Mechanical Seal
1	1142711319	Thrust Washer
2	30148390	O-Ring, Volute (128S22)
4	30148018	O-Ring, Oil Return
1	30148165	O-Ring, Bearing Cap
1	30148273	O-Ring, Bracket
1	30500172	Lip Seal, Inboard
1	30500173	Lip Seal, Outboard
1	30148161	O-Ring, Seal Gland (128S22)
1	30148163	O-Ring, Seal Gland (108C24)
1	30148393	O-Ring, Volute (108C24)
1	34800105	Loctite 263, 0.5ML
1	34800104	P-80 Lubricant, 10ML

PN 373000118 Bearing Frame Kit

Qty	Item #	Description
1	32000103	Bearing Washer
1	32100103	Bearing Nut
1	31900130	Bearing, Drive End
2	31900201	Bearing, Pump End
3	31858118	Tapered Rubber Plug
1	12100102	Wave Spring
1	12721104	Shim .005"
1	12721105	Shim .010"
1	12721106	Shim .015"
2	30148390	O-Ring, Volute (128S22)
1	30148018	O-Ring, Oil Return
1	30148165	O-Ring, Bearing Cap
1	30148273	O-Ring, Bracket
1	30148161	O-Ring, Seal Gland (128S22)
1	30148163	O-Ring, Seal Gland (108C24)
1	30148393	O-Ring, Volute (108C24)
1	30500176	Cassette Seal
1	30500185	Cassette Seal
1	30500172	Lip Seal, Inboard
1	30500173	Lip Seal, Outboard
1	1210212796	Bore Spacer

Service Parts Kits

Pump Models

PP108C24	SC108C24	VP108C24
PP128S22	SC128S22	VP128S22

Ordering Information

Parts Kits are in stock and available for shipment within 2 business days.
Please call or fax orders. Phone (503) 266-4115, Fax (503) 266-4116.
Email: Canbyparts@pioneerpump.com.

Part Number	Description
372000122.....	Mechanical Seal Kit
373000118.....	Bearing Frame Kit

Optional Parts

Additional replacement parts for this model.

Model	Description	Part Number
108C24	Impeller, CA6NM	1123012779
108C24	Impeller, CD4MCu	1122912779
108C24, 128S22.....	Shaft, 17-4	1202713103
128S22	Impeller, CA6NM	1123013104
128S22	Impeller, Heat Treated	1120713104
128S22	Impeller, CD4MCu	1122913104

Notes:

1. Part numbers listed reflect updated part numbers as of July 11, 2016. Older documentation may have different part numbers. Please consult factory if differences appear.
2. Viton O-rings are included when available.



310 South Sequoia Parkway, Canby, OR 97013 USA

Phone (503) 266-4115 ■ Fax (503) 266-4116

www.pioneerpump.com

Parts Drawing - 372000122 Mechanical Seal Parts Kit

Pump Models
128S22
108C24

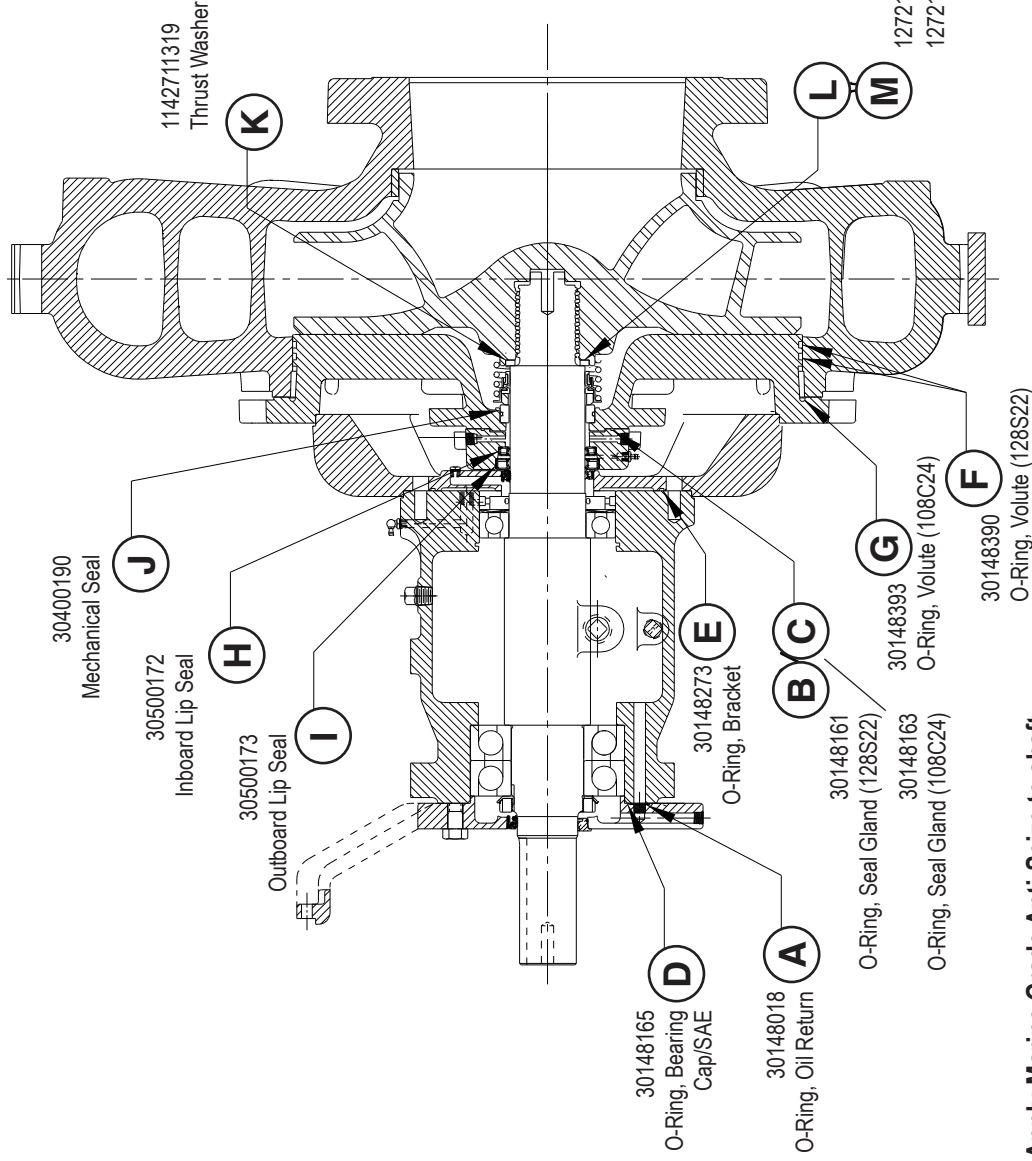

Ref#	Item#	Description	Qty
A	30148018	O-Ring, Oil Return	4
B	30148161	O-Ring, Seal Gland (128S22)	1
C	30148163	O-Ring, Seal Gland (108C24)	1
D	30148165	O-Ring, Bearing Cap/SAE	1
E	30148273	O-Ring, Bracket	1
F	30148390	O-Ring, Volute (128S22)	2
G	30148393	O-Ring, Volute (108C24)	1
H	30500172	Inboard Lip Seal	1
I	30500173	Outboard Lip Seal	1
J	30400190	Mechanical Seal	1
K	1142711319	Thrust Washer	1
L	1272110511	Shim, 0.010 Thick	1
M	1272110512	Shim, 0.015 Thick	1
N/A	34800104	P-80 Lubricant, 10 mL	1
N/A	34800105	Loctite 263, 0.5 mL	1

1272110511 Shim, 0.010 Thick
1272110512 Shim, 0.015 Thick

Apply Marine Grade Anti-Seize to shaft threads before re-installing the impeller



310 South Sequoia Parkway, Canby, OR 97013 USA
Phone (503) 266-4115 ■ Fax (503) 266-4116
www.pioneerpump.com

Parts Drawing - 373000118 Bearing Frame Parts Kit

Pump Models
128S22
108C24

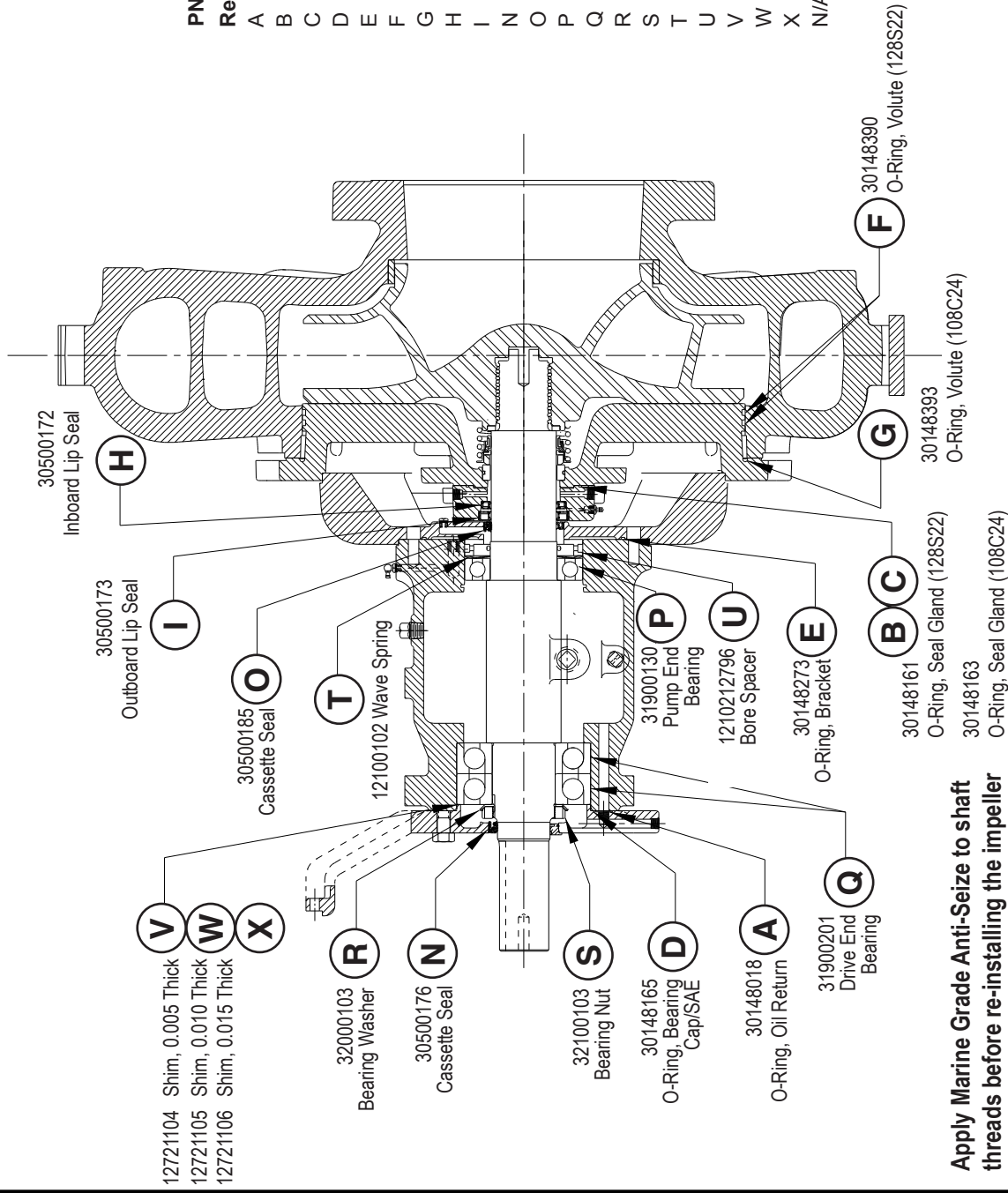

Ref#	Item#	Description	Qty
A	30148018	O-Ring, Oil Return	4
B	30148161	O-Ring, Seal Gland (128S22)	1
C	30148163	O-Ring, Seal Gland (108C24)	1
D	30148165	O-Ring, Bearing Cap/SAE	1
E	30148273	O-Ring, Bracket	1
F	30148390	O-Ring, Volute (128S22)	2
G	30148393	O-Ring, Volute (108C24)	1
H	30500172	Inboard Lip Seal	1
I	30500173	Outboard Lip Seal	1
N	30500176	Cassette Seal	1
O	30500185	Cassette Seal	1
P	31900130	Pump End Bearing	1
Q	31900201	Drive End Bearing	2
R	32000103	Bearing Washer	1
S	32100103	Bearing Nut	1
T	12100102	Wave Spring	1
U	1210212796	Bore Spacer	1
V	12721104	Shim, 0.005 Thick	1
W	12721105	Shim, 0.010 Thick	1
X	12721106	Shim, 0.015 Thick	1
N/A	31858118	Tapered Rubber Plug	3

Apply Marine Grade Anti-Seize to shaft threads before re-installing the impeller



310 South Sequoia Parkway, Canby, OR 97013 USA
Phone (503) 266-4115 ■ Fax (503) 266-4116
www.pioneerpump.com