



Service Parts Kits

Pump Models

SC64S17
PP64S17

The mechanical seal kit and bearing frame kit are offered separately. We recommend ordering both kits for a major service.

Both the Mechanical Seal and Bearing Frame kits include all of the O-rings needed for service.

Part Number	Description
372000111	Mechanical Seal Kit, includes O-rings
373000112	Bearing Frame Kit, includes O-rings

PN 372000111 Mechanical Seal Kit

Qty	Item #	Description
1	30400173	Mechanical Seal
4	30148018	O-Ring, Oil Return
1	30148160	O-Ring, Seal Gland
1	30148165	O-Ring, Bearing Cap/SAE
1	30148273	O-Ring, Brac-plate
2	30148386	O-Ring, Volute Suction Cover
1	135025795	Spring Guide
1	114264542	Impeller Thrust Washer
1	12721142	Shims 2.99 x 2.32 x .010
1	12721143	Shims 2.99 x 2.32 x .015
1	12227101	Impeller Key
1	37500141	Impeller Lock Washer Kit
1	30500184	Cassette Seal
1	34800105	Loctite 263, 0.5ML
1	34800104	P-80 Lubricant, 10ML

PN 373000112 Bearing Frame Kit

Qty	Item #	Description
1	12721104	Shim 6.28 X 5.50 X .005
1	12721105	Shim 6.28 X 5.50 X .010
1	12721106	Shim 6.28 X 5.50 X .015
1	31900102	Bearing
2	31900201	Bearing
1	32000103	Washer, Bearing
1	32100103	Nut, Bearing
4	30148018	O-Ring, Oil Return
1	30148160	O-Ring, Seal Gland
1	30148165	O-Ring, Bearing Cap/SAE
1	30148273	O-Ring, Brac-plate
1	30148386	O-Ring, Volute Suction Cover
1	30500176	Cassette Seal
2	30500184	Cassette Seal
3	31858118	Tapered Rubber Plug

Service Parts Kits

Pump Models

SC64S17

PP64S17

Ordering Information

Parts Kits are in stock and available for shipment within 2 business days.
Please call or fax orders. Phone (503) 266-4115, Fax (503) 266-4116.

Part Number	Description
372000111	Mechanical Seal Service Kit
373000112	Bearing Frame Service Kit

Optional Parts

Additional parts for this model.

Model	Description	Part Number
64S17	Wear Ring, Eye (Impeller)	10925149
64S17	Wear Ring, (Suction Cover).....	109025190
64S17	Impeller	112305985

Seal Installation Tool for 2.50" Shafts

64S17	Installation Tool	36711710236B
-------------	-------------------------	--------------

Notes:

1. Part numbers listed reflect updated part numbers as of May 11, 2016. Older documentation may have different part numbers. Please consult factory if differences appear.
2. Viton O-rings are included when available.



310 South Sequoia Parkway, Canby, OR 97013 USA

Phone (503) 266-4115 ■ Fax (503) 266-4116

www.pioneerpump.com

Parts Drawing - 372000111 Mechanical Seal Parts Kit

Pump Models
 SC64S17
 PP64S17

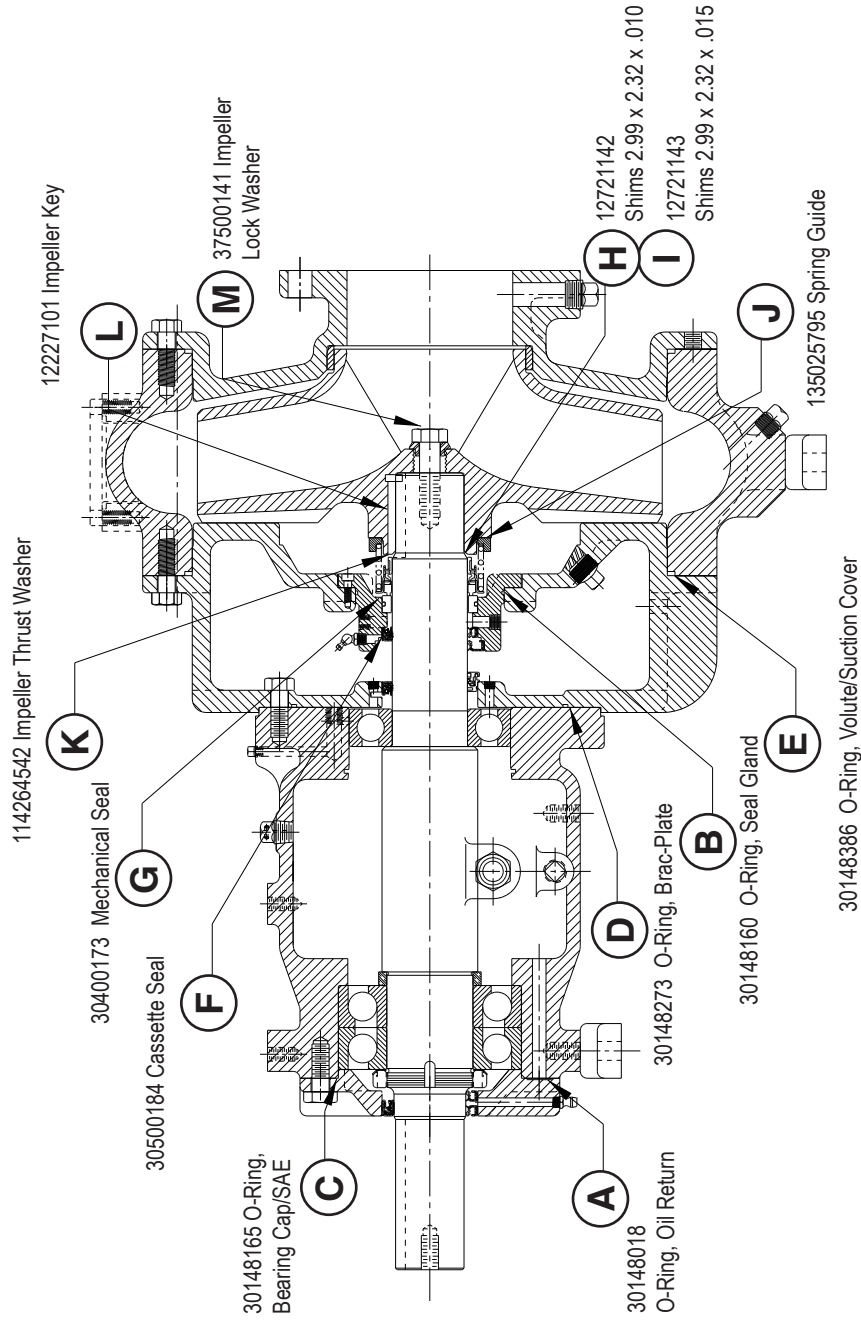

PN 372000111 Mechanical Seal Kit

Ref.	Item Number	Description	Qty.
A	30148018	O-Ring, Oil Return	4
B	30148160	O-Ring, Seal Gland	1
C	30148165	O-Ring, Bearing Cap/SAE	1
D	30148273	O-Ring, Brac-plate	1
E	30148386	O-Ring, Volute/Suction Cover	2
F	30500184	Cassette Seal	1
G	30400173	Mechanical Seal	1
H	12721142	Shim, .010 Thick	1
I	12721143	Shim, .015 Thick	1
J	135025795	Spring Guide	1
K	114264542	Impeller Thrust Washer	1
L	12227101	Impeller Key	1
M	37500141	Impeller Lock Washer*	1
N/A	34800104	P-80 Lubricant, 10 mL	1
N/A	34800105	Loctite 263, 0.5 mL	1

*Torque Specification: 330 lb-ft



310 South Sequoia Parkway, Canby, OR 97013 USA
 Phone (503) 266-4115 ■ Fax (503) 266-4116
www.pioneerpump.com

Parts Drawing - 373000112 Bearing Frame Kit

Pump Models

SC64S17
PP64S17

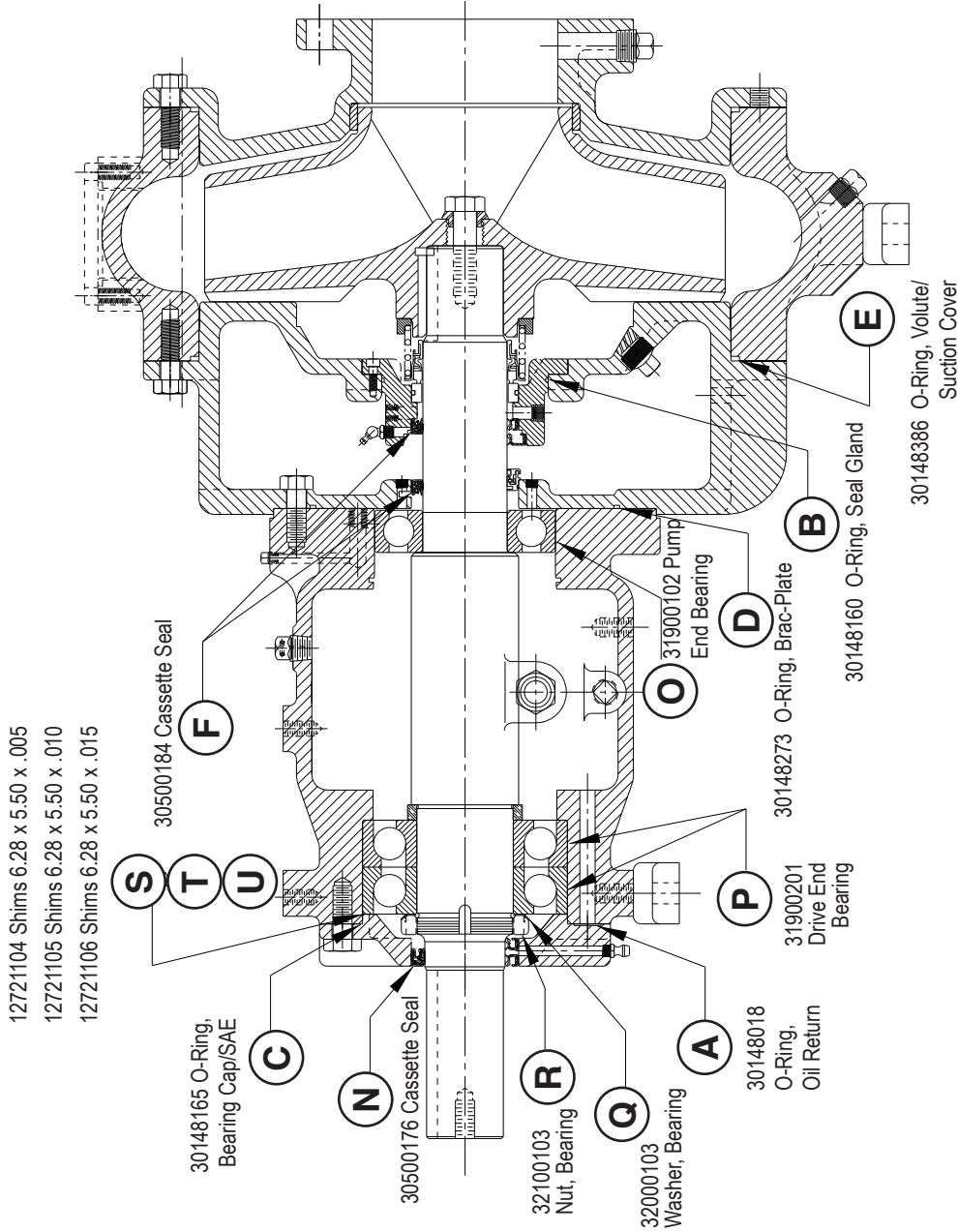

PN 373000112 Bearing Frame Kit			
Ref.	Item Number	Description	Qty.
A	30148018	O-Ring, Oil Return	4
B	30148160	O-Ring, Seal Gland	1
C	30148165	O-Ring, Bearing Cap/SAE	1
D	30148273	O-Ring, Brac-plate	1
E	30148386	O-Ring, Volute/Suction Cover	2
F	30500184	Cassette Seal	2
N	30500176	Cassette Seal	1
O	31900102	Pump End Bearing	1
P	31900201	Drive End Bearing	2
Q	32000103	Washer, Bearing	1
R	32100103	Nut, Bearing	1
S	12721104	Shim, .005 Thick	1
T	12721105	Shim, .010 Thick	1
U	12721106	Shim, .015 Thick	1
N/A	31858118	Tapered Rubber Plug	3



310 South Sequoia Parkway, Canby, OR 97013 USA
Phone (503) 266-4115 ■ Fax (503) 266-4116
www.pioneerpump.com