



Service Parts Kits

Pump Models

PP66S12	SC66S12	VP66S12
PP66S14	SC66S14	VP66S14
PP88S12	SC88S12	VP88S12

The mechanical seal kit and bearing frame kit are offered separately. We recommend ordering both kits for a major service.

Both the Mechanical Seal and Bearing Frame kits include all of the O-rings needed for service.

Part Number	Description
372000101	Mechanical Seal Kit, includes O-rings
373000100	Bearing Frame Kit, includes O-rings



PN 372000101 Mechanical Seal Kit

Qty	Item #	Description
1	12227109	Impeller Key
1	12721107	Shim 2.18 X .78 X .005
1	12721108	Shim 2.18 X .78 X .010
1	12721109	Shim 2.18 X .78 X .015
1	12721116	Shim 2.18 X .78 X .030
1	30400172	Mechanical Seal
1	30148345	O-Ring, Cleanout Cover
1	30148379	O-Ring, Bracket
2	30148383	O-Ring, Volute
4	30148018	O-Ring, Drain Back
4	30148112	O-Ring, Bracket Capscrew
1	30148160	O-Ring, Carrier
1	30148165	O-Ring, Bearing Cap
1	34800104	P-80 Lubricant, 10ML
1	34800105	Loctite 263, 0.5ML
1	37500121	Lock Washer Kit
1	30500179	Cassette Seal

PN 373000100 Bearing Frame Kit

Qty	Item #	Description
1	12100101	Wave Spring
1	12721101	Shim 6.28 X 5.50 X .005
1	12721102	Shim 6.28 X 5.50 X .010
1	12721103	Shim 6.28 X 5.50 X .015
1	31900101	Bearing
1	31900103	Bearing
1	32000102	Washer, Bearing
1	32100102	Nut, Bearing
1	30148345	O-Ring, Cleanout Cover
1	30148379	O-Ring, Bracket
2	30148383	O-Ring, Volute
4	30148018	O-Ring, Drain Back
4	30148112	O-Ring, Bracket Capscrew
1	30148160	O-Ring, Carrier
1	30148165	O-Ring, Bearing Cap
1	12113177	Bearing Spacer
3	31858118	Tapered Rubber Plug
1	30500176	Cassette Seal
2	30500179	Cassette Seal

Service Parts Kits

Pump Models

PP66S12	SC66S12	VP66S12
PP66S14	SC66S14	VP66S14
PP88S12	SC88S12	VP88S12

Ordering Information

Parts Kits are in stock and available for shipment within 2 business days.

Please call or fax orders. Phone (503) 266-4115, Fax (503) 266-4116.

Email: Canbyparts@pioneerpump.com.

Part Number	Description
372000101	Mechanical Seal Repair Kit
373000100	Bearing Frame Repair Kit

Optional Parts

Additional parts for these models.

Model	Description	Part Number
66S12	Wear Ring	10902175
66S12	Impeller, CA6NM SS	11230145
66S14	Wear Ring	10902175
66S14	Impeller, CA6NM SS	11230669R
88S12	Wear Ring	10902270
88S12	Impeller, CA6NM SS	112301143

Seal Installation Tool for 2.50" Shafts

All Models Installation Tool 3671710236B

Notes:

1. Part numbers listed reflect updated part numbers as of June 23, 2016. Older documentation may have different part numbers. Please consult factory if differences appear.
2. Viton O-rings are included when available.



310 South Sequoia Parkway, Canby, OR 97013 USA

Phone (503) 266-4115 ■ Fax (503) 266-4116

www.pioneerpump.com

Parts Drawing - 372000101 Mechanical Seal Parts Kit

Pump Models
 PP66S12
 PP66S14
 PP88S12
 SC66S12
 SC66S14
 SC88S12

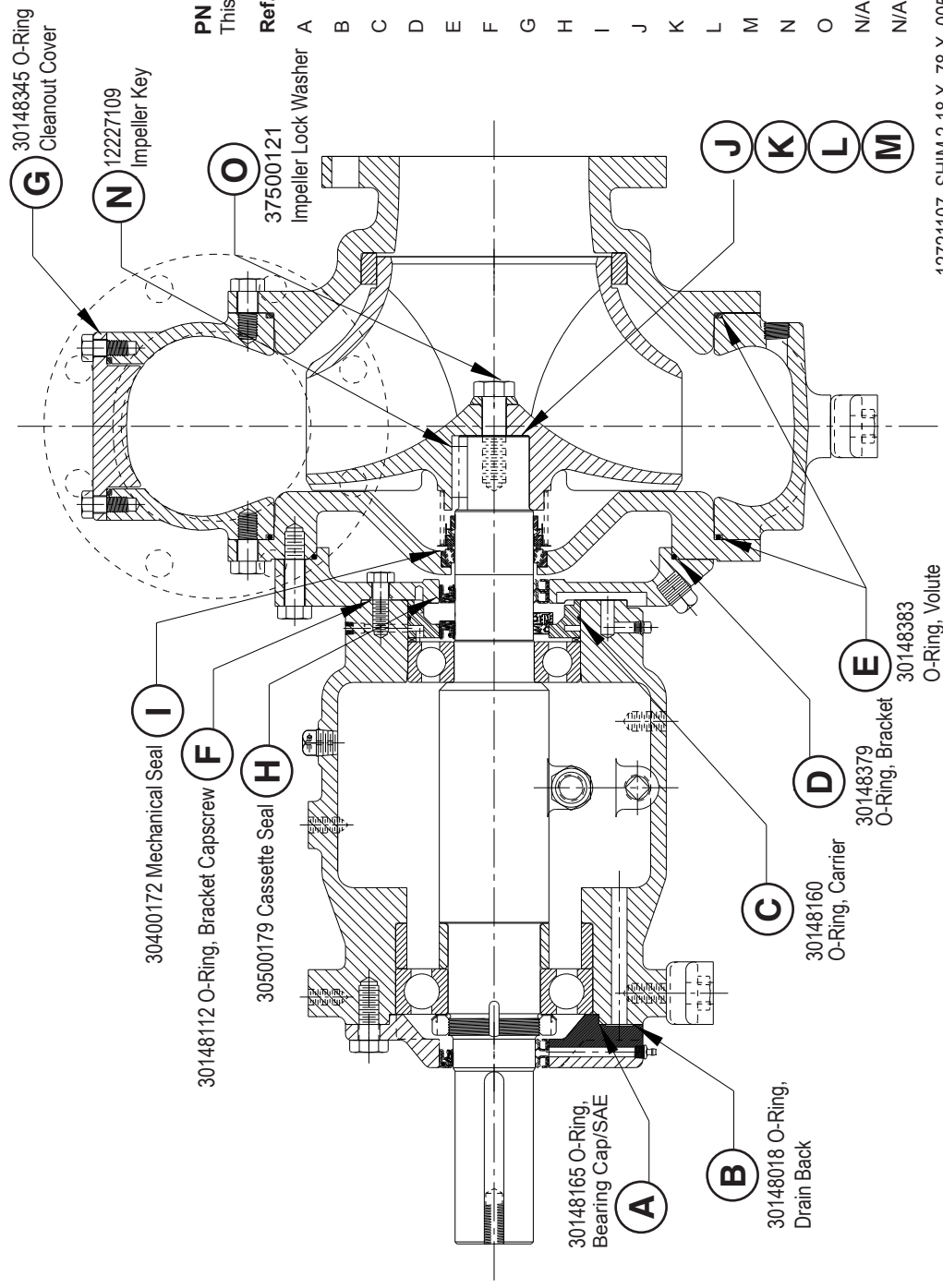

PN 372000101 Mechanical Seal Kit
 This kit includes o-rings

Ref. Item Number	Description	Qty.
A	30148165 O-Ring, Bearing Cap/SAE	1
B	30148018 O-Ring, Drain Back	4
C	30148160 O-Ring, Carrier	1
D	30148379 O-Ring, Bracket	1
E	30148383 O-Ring, Volute	2
F	30148112 O-Ring, Bracket Capscrew	4
G	30148345 O-Ring, Cleanout Cover	1
H	30500179 Cassette Seal	1
I	30400172 Mechanical Seal	1
J	12721107 Shim, .005 Thick	1
K	12721108 Shim, .010 Thick	1
L	12721109 Shim, .015 Thick	1
M	12721116 Shim, .030 Thick	1
N	12227109 Impeller Key	1
O	37500121 Impeller Lock Washer*	1
N/A	34800104 P-80 Lubricant, 10 mL	1
N/A	34800105 Loctite 263, 0.5 mL	1

12721107 SHIM 2.18 X .78 X .005
 12721108 SHIM 2.18 X .78 X .010
 12721109 SHIM 2.18 X .78 X .015
 12721116 SHIM 2.18 X .78 X .030

*Torque Specification: 330 lb-ft

310 South Sequoia Parkway, Canby, OR 97013 USA
 Phone (503) 266-4115 ■ Fax (503) 266-4116
www.pioneerpump.com



Parts Drawing - 373000100 Bearing Frame Parts Kit

Pump Models

PP66S12 SC66S12 VP66S12
 PP66S14 SC66S14 VP66S14
 PP88S12 SC88S12 VP88S12

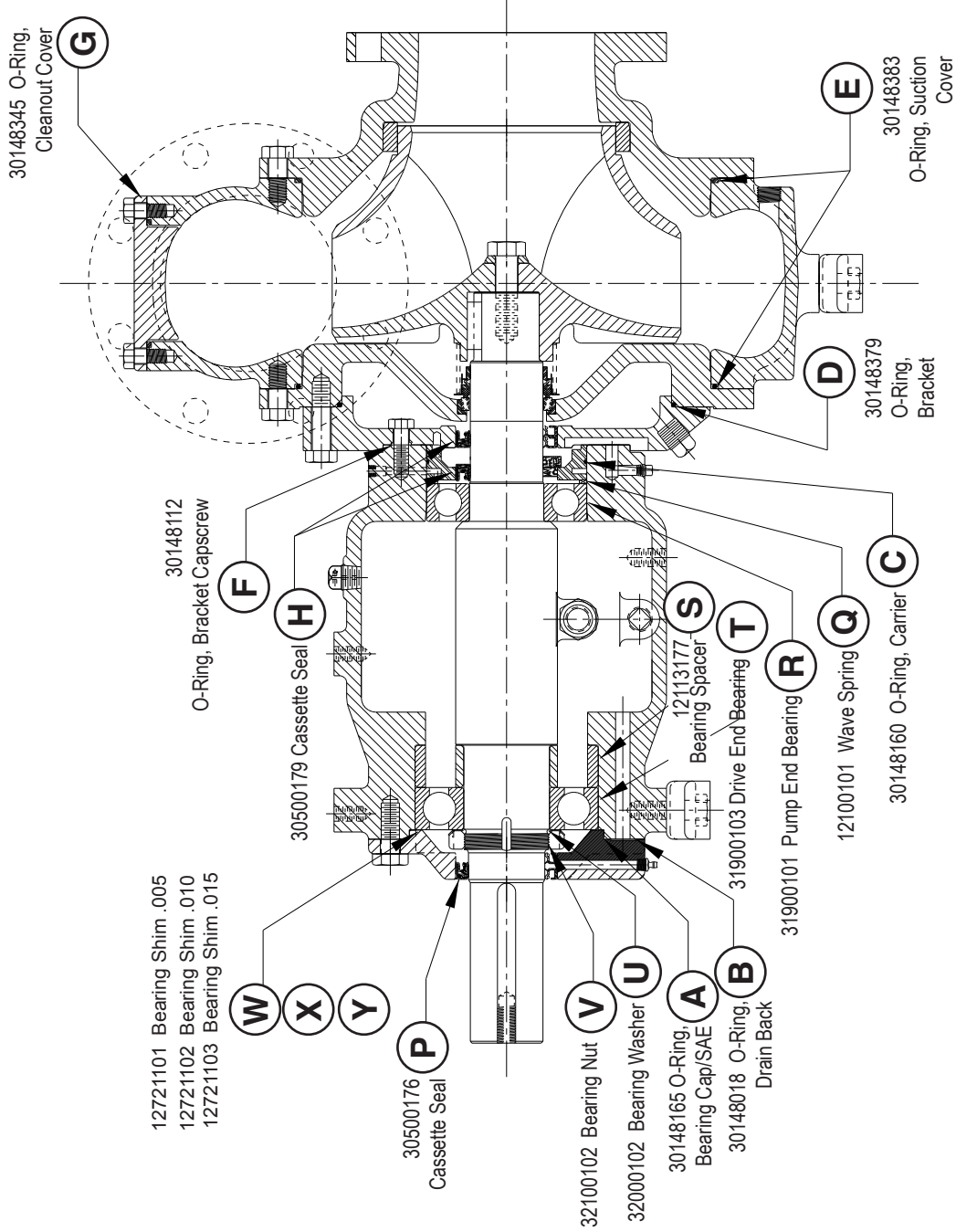

PN 373000100 Bearing Frame Kit

Ref.	Item Number	Description	Qty.
A	30148165	O-Ring, Bearing Cap/SAE	1
B	30148018	O-Ring, Drain Back	4
C	30148160	O-Ring, Carrier	1
D	30148379	O-Ring, Bracket	1
E	30148383	O-Ring, Volute	2
F	30148112	O-Ring, Bracket Capscrew	4
G	30148345	O-Ring, Cleanout Cover	1
H	30500179	Cassette Seal	2
P	30500176	Cassette Seal	1
Q	12100101	Wave Spring	1
R	31900101	Pump End Bearing	1
S	12113177	Bearing Spacer	1
T	31900103	Drive End Bearing	1
U	32000102	Washer, Bearing	1
V	32100102	Nut, Bearing	1
W	12721101	Shim, .005 Thick	1
X	12721102	Shim, .010 Thick	1
Y	12721103	Shim, .015 Thick	1
N/A	31858118	Tapered Rubber Plug	3



310 South Sequoia Parkway, Canby, OR 97013 USA
 Phone (503) 266-4115 ■ Fax (503) 266-4116
www.pioneerpump.com